



SPECIFICATIONS

| | |
|--|--|
| DN mm | DN400 - DN600 |
| DN inch | 16" - 24" |
| Temperature | EPDM -10°C to 120°C |
| Type of body | Flange |
| Application | Clear water, Fire protection networks, Pumping stations |
| Flange | PN 16 |
| Valve design standard | EN 12334, ASME B16.1, ASME B16.42 |
| Flange drilling | EN 1092-2 |
| Tightness test (according to EN 12266-1) | Resistance and tightness of the body (1.5 x allowable operating pressure), Tightness of the seat, (1.1 x allowable operating pressure) |
| Options | Other specifications on request |

ADVANTAGES

1. Hydraulic design to reduce head loss and water hammer
2. Any position installation
3. Excellent tightness assured by closing system
4. Silent operation
5. Robust closing system design
6. Stainless steel spring to assure frequent opening / closing operation
7. Easy maintenance: the guide can be removed easily
8. Lateral body bosses can be drilled on request to enable the mounting of pressure gauge
9. Cable-pass for pump

DIMENSIONS

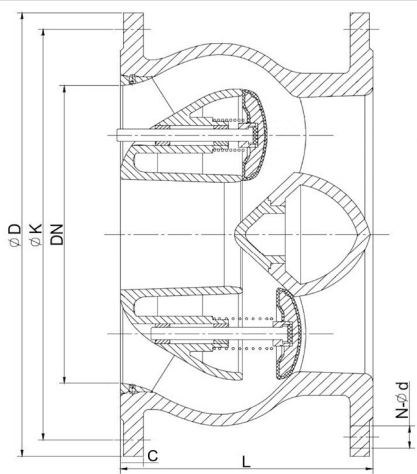

| DN mm | DN inch | PFA | L | C | ØD | ØK | N-Ød |
|-------|---------|-----|-----|------|-----|-----|--------|
| 400 | 16" | 16 | 310 | 24.5 | 580 | 525 | 16-Ø31 |
| 450 | 18" | 16 | 330 | 25.5 | 640 | 585 | 20-Ø31 |
| 500 | 20" | 16 | 350 | 26.5 | 715 | 650 | 20-Ø34 |
| 600 | 24" | 16 | 390 | 30 | 840 | 770 | 20-Ø37 |

NOMENCLATURE

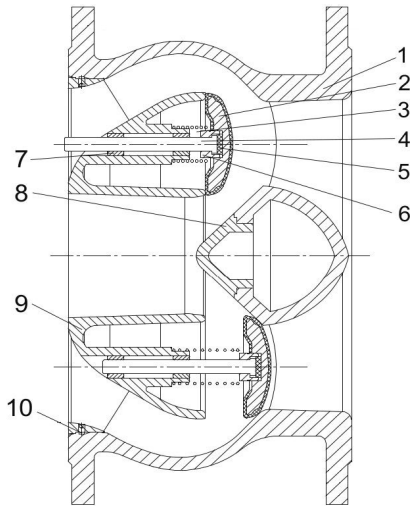

| Designation | Materials |
|-------------|--------------------------------------|
| 1.Body | Ductile iron GGG50 |
| 2.Disc | Ductile iron GGG50 with EPDM coating |
| 3.Spring | Stainless steel 304/316 |
| 4.Stem | Stainless steel 420/304/316 |
| 5.Washer | Nylon/EPDM |
| 6.Nut | Stainless steel 420/304 |
| 7.Bushing | Bronze-C61900 |
| 8.Plug | Ductile iron GGG50 |
| 9.Diffuser | Ductile iron GGG50 |
| 10.Set crew | Stainless steel 304 |

HEADLOSS

