



SPECIFICATIONS

DN mm	DN50 - DN600
DN inch	2" - 28"
Temperature	0°C to 80°C
Type of body	Flange
Application	Clear Water, Waste water, Water supply, Pumping station
Flange	PN 10
Norm	EN1092-2
Face to face	DIN F6
Options	Other specifications on request

ADVANTAGES

1. Prevent reverse flow automatically
2. Coating: Fusion bonded epoxy coating
3. 100% flow area, full waterway for low headloss
4. Rubber seated, 100% water tightness
5. Valve is designed to have a 45 degree angle to minimize closure time
6. Cover is removable and allow removal of the flexible disc without removing the valve
7. Horizontal or vertical installation

DIMENSIONS

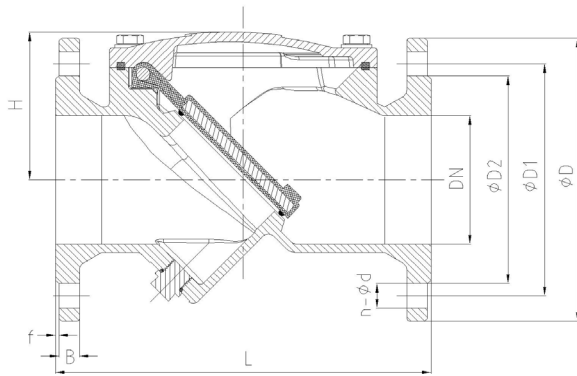

DN mm	DN inch	PFA	L	D	K	PN
50	2"	10	200	165	125	10
65	2"1/2	10	240	185	145	10
80	3"	10	260	200	260	10
100	4"	10	300	220	180	10
150	6"	10	400	285	240	10
200	8"	10	500	340	295	10
250	10"	10	600	395/405	350/355	10
300	12"	10	700	445/460	400/410	10
400	16"	10	/	/	/	/
500	20"	10	/	/	/	/
600	28"	10	/	/	/	/

NOMENCLATURE

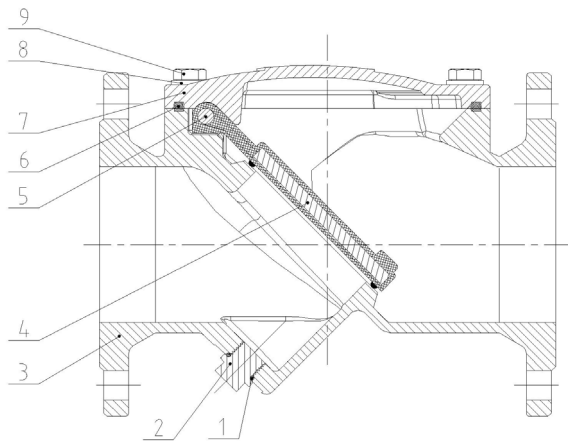

Designation	Materials
3.Stem	WCB
2.Disc	WCB encapsulated with EPDM-rubber
4.Cover Bolts	Stainless steel 304 (A2-70)
5.Bonnet Gasket	NBR rubber
6.Plug	Stainless steel 304 (A2-70)

