



SPECIFICATIONS

DN mm	DN15 - DN500
DN inch	1/2" - 20"
Temperature	-10°C to 350°C
Type of body	Double flanges
Application	Clear water, Fire protection, Irrigation, Sewage
Flange	PN 10, PN 16, PN 25, PN 40
Valve Standard	EN 1171, EN 1074
Face to face	DIN 3202 F1
Flange drilling	EN 1092-2
Tightness test	EN 12266-1
Epoxy coating	150µm (standard), other thickness on request
Options	Other specifications on request

ADVANTAGES

1. Excellent performance: low pressure drop and low torque
2. Full bore design
3. Wedge fully encapsulated in moulded EPDM
4. Linear sealing design provides better sealing and lower closing torque
5. Three independant stem seals offering triple safety: PTFE dust cover protects against dirt outside
6. A polyamid bearing with 3 NBR O-rings protects against galvanic corrosion
7. Operation: valve could be operated by hand wheel/head cap/worm gear/electric actuator

DIMENSIONS

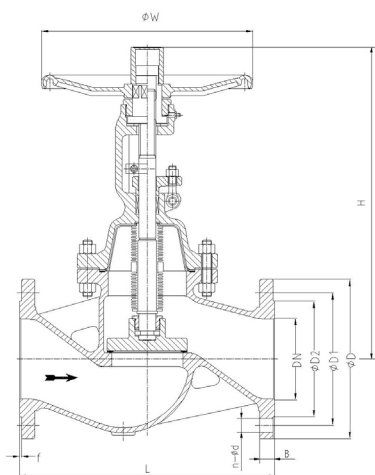

DN mm	DN inch	PFA	L	ØD	ØD1	ØD2	B	f	H	ØW	n-Ød
15	1/2"	10	130	95	65	46	14	2	196	140	4-Ø14
		16									
		25									
		40									
20	3/4"	10	150	105	75	56	16	2	196	140	4-Ø14
		16									
		25									
		40									
25	1"	10	160	115	85	65	16	3	205	160	4-Ø14
		16									
		25									
		40									
32	1 1/4"	10	180	140	100	76	18	3	205	160	4-Ø19
		16									
		25									
		40									
40	1 1/2"	10	200	150	110	84	18	3	222	180	4-Ø19
		16									
		25									
		40									
50	2"	10	230	165	125	99	20	3	224	180	4-Ø19
		16									
		25									
		40									
65	2 1/2"	10	290	185	145	118	20	3	240	220	4-Ø19
		16					22				8-Ø19
		25									
		40									
80	3"	10	310	200	160	132	20	3	265	250	8-Ø19
		16					24				
		25									
		40									
100	4"	10	350	220	180		22	3	415	300	8-Ø19
		16		235	190	24	8-Ø23				
		25									
		40									
125	5"	10	400	250	210		22	3	460	350	8-Ø19
		16		270	220	26	8-Ø28				
		25									
		40									
150	6"	10	480	285	240		24	3	585	400	8-Ø23
		16		300	250	28	8-Ø28				
		25									
		40									
200	8"	10	600	340	295	266	24	3	705	500	8-Ø23
		16		360	310	274	30				12-Ø23
		25		375	320	284	34				12-Ø28
		40									12-Ø31
250	10"	10	730	395	350	319	26	3	995	500	12-Ø23
		16		405	355	330	32				12-Ø28
		25		425	370	330	32				12-Ø31
		40		450	385	345	38				12-Ø34
300	12"	10	850	445	400	370	26	4	1100	500	12-Ø23
		16		460	410	370	28				12-Ø28
		25		485	430	389	34				16-Ø31
		40		515	450	409	42				16-Ø34
350	14"	10	980	505	460	429	26	4	1145	600	16-Ø23
		16		520	470	429	30				16-Ø28
		25		555	490	448	38				16-Ø34
		40		580	510	465	46				16-Ø37
400	16"	10	1100	565	515	480	26	4	1480	600	16-Ø28
		16		580	525	480	32				16-Ø31
		25		620	550	503	40				16-Ø37
		40		660	585	535	50				16-Ø41
450	18"	10	1200	615	565	530	28	4	1560	650	20-Ø28
		16		640	585	548	40				20-Ø31
		25		670	600	548	46				20-Ø37
		40		685	610	560	57				20-Ø41
500	20"	10	1250	670	620	582	28	4	1680	700	20-Ø28
		16		715	650	609	44				20-Ø34
		25		730	660	609	48				20-Ø37
		40		755	670	615	57				20-Ø44



NOMENCLATURE

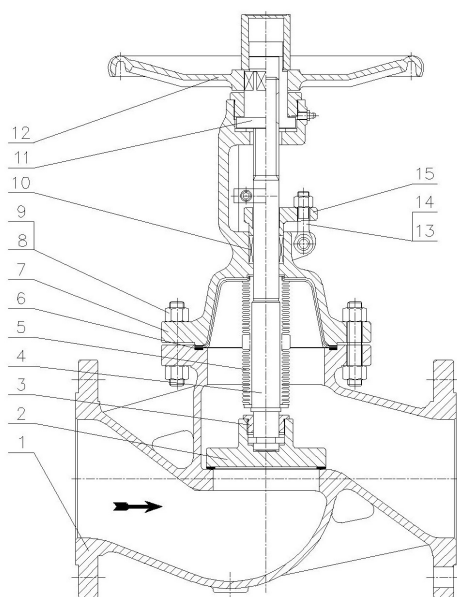

Designation	Materials
1. Body	Carbon steel
2. Disc	Carbon steel
3. Disc nut	Carbon steel
4. Stem	Stainless steel 420
5. Bellows	Stainless steel 304
6. Gasket	Stainless steel 304 + Graphite
7. Bonnet	Carbon steel
8. Bolt	Steel
9. Nut	Steel
10. Packing	Graphite
11. Yoke nut	Copper
12. Handwheel	Carbon steel
13. Gland	Carbon steel
14. Gland eyebolt	Steel
15. Nut	Steel