

### SPECIFICATIONS

DN mm	DN 50 - DN 1600
DN inch	2" - 64"
Temperature	-10 +70°C
Type of body	Flange
Application	Fresh water/ salt water
Flange	PN 10/16/25/40 JIS 10K/16K Table D/E/AS 4087-16 Class150/Class300
Valve design standard	EN 12334, ASME B16.1, ASME B16.42
Flange drilling	EN 1092-2
Tightness test (according to EN 12266-1)	Resistance and tightness of the body (1.5 x allowable operating pressure), Tightness of the seat, (1.1 x allowable operating pressure)
Options	Other specifications on request



### ADVANTAGES

1. Reasonable and streamlined design
2. The noise is minimum for direct flow or backflow
3. Head loss is only 0.05Bar with 2m/s
4. The velocity of backflow is only 0.2s
5. Integral body and flow guide
6. EPDM/NBR rubber fully coated disc
7. WRAS epoxy coating and Min. 250um

# DIMENSIONS

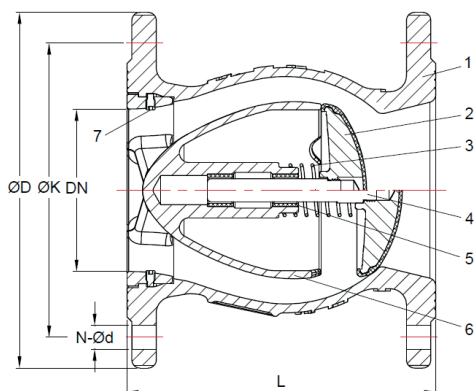

DN	L	ØD				ØK				N-Ød			
		PN10	PN16	PN25	PN40	PN10	PN16	PN25	PN40	PN10	PN16	PN25	PN40
50	150	165				125				4-Ø19			
65	170	185				145				4-Ø19		8-Ø19	
80	180	200				160				8-Ø19			
100	190	220		235		180		190		8-Ø19		8-Ø23	
125	200	250		270		210		220		8-Ø19		8-Ø28	
150	210	285		300		240		250		8-Ø23		8-Ø28	
200	230	340	360	375	295		310	320	8-Ø23	12-Ø23	12-Ø28	12-Ø31	
250	250	405	405		350	355	370		12-Ø23	12-Ø28	12-Ø31		
300	270	460	460		400	410	430		12-Ø23	12-Ø28	16-Ø31		
350	290	520	520		460	470	490		16-Ø23	16-Ø28	16-Ø34		

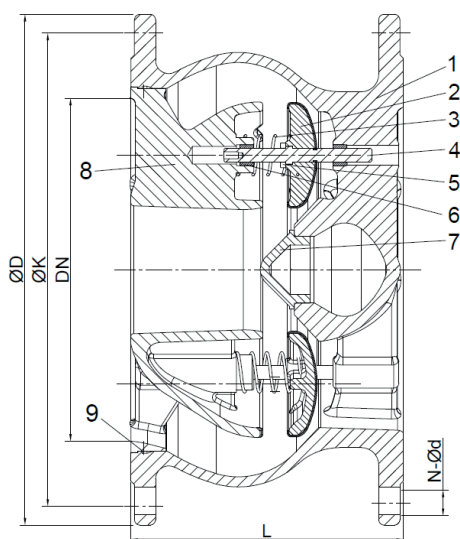

DN	L	ØD			ØK			N-Ød		
		PN10	PN16	PN25	PN10	PN16	PN25	PN10	PN16	PN25
400	310	580	620	620	515	525	550	16-Ø28	16-Ø31	16-Ø37
450	330	640	670	670	565	585	600	20-Ø28	20-Ø31	20-Ø37
500	350	715	730	730	620	650	660	20-Ø28	20-Ø34	20-Ø37
600	390	780	840	845	725	770	770	20-Ø31	20-Ø37	20-Ø40

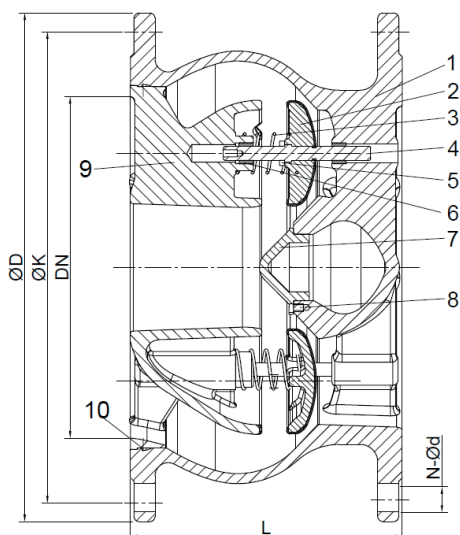

DN	L	ØD		ØK		N-Ød	
		PN10	PN16	PN10	PN16	PN10	PN16
700	430	910		840		24-Ø31	24-Ø37
800	470	1025		950		24-Ø34	24-Ø41
900	510	1125		1050		28-Ø34	28-Ø41
1000	550	1255		1160	1170	28-Ø37	28-Ø44
1200	630	1485		1380	1390	32-Ø40	32-Ø49
1400	710	1685		1590		36-Ø43	36-Ø49
1600	790	1930		1820		40-Ø49	32-Ø56



## NOMENCLATURE

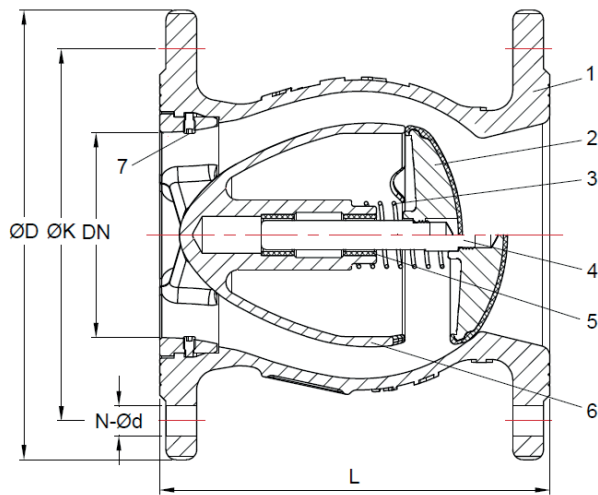

Designation	Materials	Option
1.Body	GJS 500-7	CF8
2.Disc	CF8+EPDM	
3.Spring	AISI 302	
4.Stem	AISI 304	
5.Bush	C61900	
6.Diffuser	GJS 500-7	CF8
7.Set screw	A2	

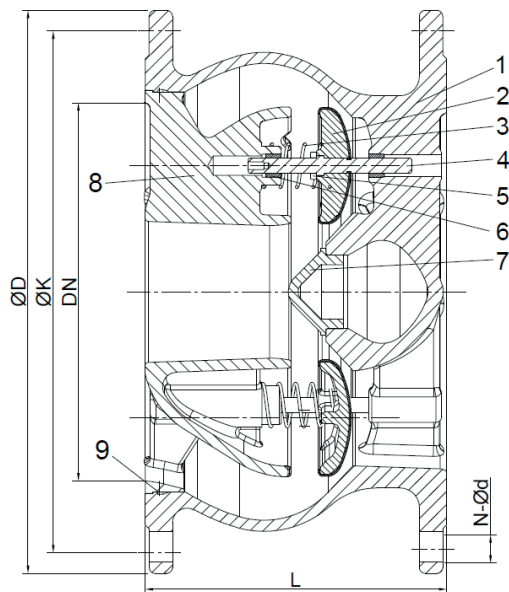

Designation	Materials
1.Body	GJS 500-7
2.Disc	CF8+EPDM
3.Spring	AISI 302
4.Stem	AISI 420
5.Nut	AISI304
6.Bush	C61900
7.Plug	GJS 500-7
8.Diffuser	GJS 500-7
9.Set screw	A2

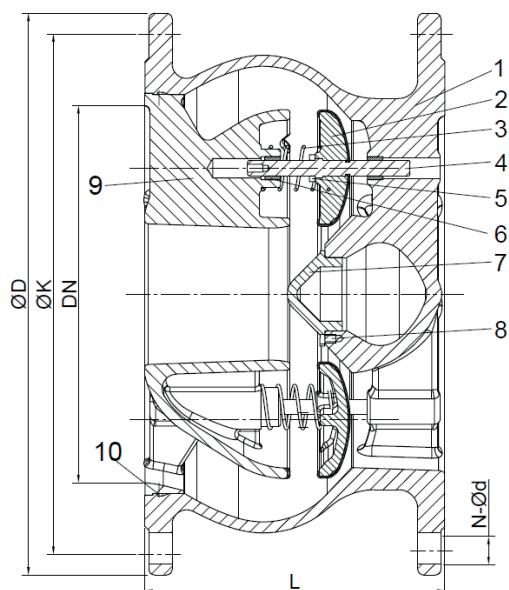

Designation	Materials
1.Body	GJS 500-7
2.Disc	GJS 500-7+EPDM
3.Spring	AISI 304
4.Stem	AISI 304
5.Nut	AISI304
6.Bronze bush	C61900
7.Plug	GJS 500-7
8.Bolt	A2
9.Diffuser	GJS 500-7
10.Set screw	A2

# HEADLOSS

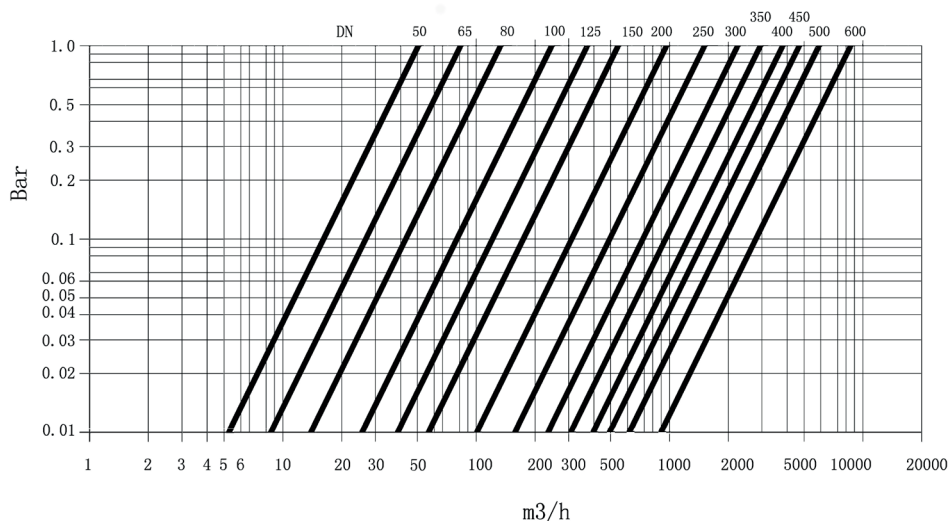

Omeax SARL

Contact@omeax.com - <http://www.omeax.com>

Omeax is not responsible for any possible errors in catalogue, brochures and on website. This datasheet is subject to change without notice. All right reserved.