

SPECIFICATIONS

| | |
|----------------------|--|
| DN mm | DN200 - DN2000 (DN2200 to DN3000 on request) |
| DN inch | 8" - 80" (88" To 120" on request) |
| Seal | Seal Stainless steel body seats |
| Temperature | -10°C to 80°C |
| Type of body | Double flanged |
| Application | Water transmission pipeline, pumping stations water Distribution network, irrigation (filtered water) fire Protection networks |
| Flange | PN10, PN16, PN25, PN40 |
| Face to face | EN 558-1 series 14, ISO 5752 series 14 |
| Shell tightness test | According to EN 12266-1 resistance and tightness of the body : test P11 (1,5 x allowable operating pressure) |
| Seat tightness test | According to EN 12266-1 seat tightness : test P12 rate E (1,1 x allowable operating pressure) |
| Top flange | EN ISO 5211 |
| Options | Other specifications on request |

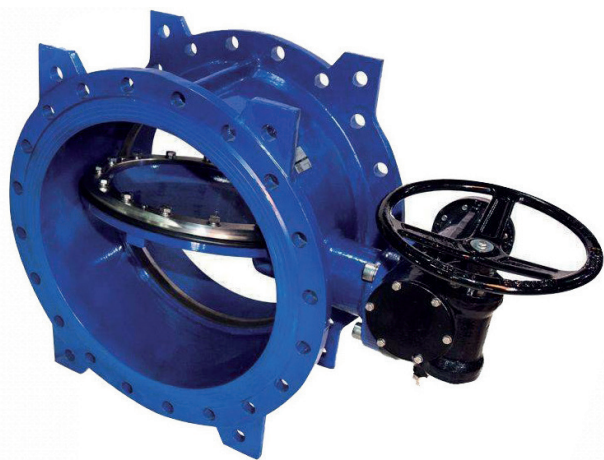

ADVANTAGES

- Wide range of operating pressures and diameters.
- Double eccentric butterfly valve reduces operating torque and seal wear.
- Low pressure drop.
- Stainless steel body seats, ensuring the reliability of the sealing system over time.
- Profiled seal attached to the butterfly.
- Worm gearbox with visual position indicator and prepared for electric actuator.
- RAL Blue epoxy coating inside and outside minimum 250 microns.
- Conforms to European standards
- WRAS or ACS sanitary conformity certificate.

DIMENSIONS

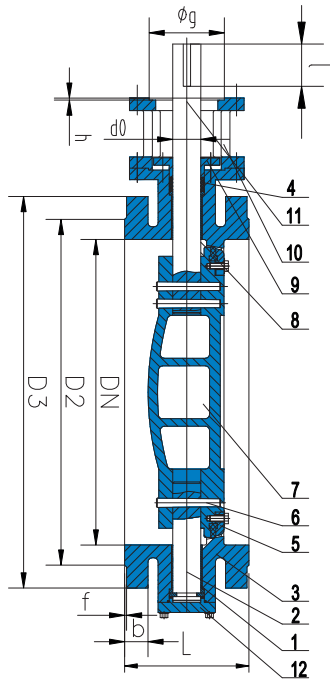
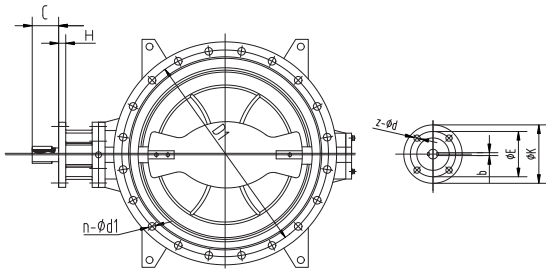

Dimensions / PN10

| DN | L | | D1 | N-d1 | D2 | D3 | B | F | C | D0 | Key | | UPPER FLANGE | | |
|------|-----------|-----------|------|-------|------|------|------|---|-----|-----|----------|-----|--------------|------|-------|
| | 13 Series | 14 Series | | | | | | | | | B*1 | K | E | Z-d | G-h |
| 100 | 127 | 190 | 180 | 8-18 | 156 | 220 | 19 | 3 | 39 | 16 | 5*30 | 90 | 70 | 4-10 | 55-2 |
| 125 | 140 | 200 | 210 | 8-19 | 184 | 250 | 19 | 3 | 45 | 20 | 6*35 | 125 | 102 | 4-12 | 70-3 |
| 150 | 140 | 210 | 240 | 8-23 | 211 | 285 | 19 | 3 | 45 | 20 | 6*35 | 125 | 102 | 4-12 | 70-3 |
| 200 | 152 | 230 | 295 | 8-23 | 266 | 340 | 20 | 3 | 45 | 25 | 8*35 | 125 | 102 | 4-12 | 70-3 |
| 250 | 165 | 250 | 350 | 12-23 | 319 | 395 | 22 | 3 | 45 | 25 | 8*35 | 125 | 102 | 4-12 | 70-3 |
| 300 | 178 | 270 | 400 | 12-23 | 370 | 445 | 24.5 | 4 | 50 | 30 | 8*45 | 175 | 140 | 4-18 | 100-4 |
| 350 | 190 | 290 | 460 | 16-23 | 429 | 505 | 24.5 | 4 | 50 | 40 | 12*45 | 210 | 165 | 4-22 | 130-5 |
| 400 | 216 | 310 | 515 | 16-28 | 480 | 565 | 24.5 | 4 | 50 | 45 | 14*45 | 210 | 165 | 4-22 | 130-5 |
| 450 | 222 | 330 | 565 | 20-28 | 530 | 615 | 25.5 | 4 | 50 | 45 | 14*45 | 210 | 165 | 4-22 | 130-5 |
| 500 | 229 | 350 | 620 | 20-28 | 582 | 670 | 26.5 | 4 | 70 | 52 | 16*60 | 210 | 165 | 4-22 | 130-5 |
| 600 | 267 | 390 | 725 | 20-31 | 682 | 780 | 30 | 5 | 90 | 55 | 2*16*70 | 300 | 254 | 8-18 | 200-5 |
| 700 | 292 | 430 | 840 | 24-31 | 794 | 895 | 32.5 | 5 | 90 | 65 | 2*18*70 | 300 | 254 | 8-18 | 200-5 |
| 800 | 318 | 470 | 950 | 24-34 | 901 | 1015 | 35 | 5 | 100 | 70 | 2*20*80 | 300 | 254 | 8-18 | 200-5 |
| 900 | 330 | 510 | 1050 | 28-34 | 1001 | 1115 | 37.5 | 5 | 100 | 80 | 2*22*80 | 300 | 254 | 8-18 | 200-5 |
| 1000 | 410 | 550 | 1160 | 28-37 | 1112 | 1230 | 40 | 5 | 145 | 92 | 2*25*130 | 300 | 254 | 8-18 | 200-5 |
| 1200 | 470 | 630 | 1380 | 32-41 | 1328 | 1455 | 45 | 5 | 145 | 100 | 2*28*130 | 350 | 298 | 8-22 | 230-5 |

Dimensions / PN16

| DN | L | | D1 | N-d1 | D2 | D3 | B | F | C | D0 | Key | | UPPER FLANGE | | |
|------|-----------|-----------|------|-------|------|------|------|---|-----|-----|----------|-----|--------------|------|-------|
| | 13 Series | 14 Series | | | | | | | | | B*1 | K | E | Z-d | G-h |
| 100 | 127 | 190 | 180 | 8-19 | 156 | 220 | 19 | 3 | 39 | 16 | 5*30 | 90 | 70 | 4-10 | 55-2 |
| 125 | 140 | 200 | 210 | 8-19 | 184 | 250 | 19 | 3 | 45 | 20 | 6*35 | 125 | 102 | 4-12 | 70-3 |
| 150 | 140 | 210 | 240 | 8-23 | 211 | 285 | 19 | 3 | 45 | 20 | 6*35 | 125 | 102 | 4-12 | 70-3 |
| 200 | 152 | 230 | 295 | 12-23 | 266 | 340 | 20 | 3 | 45 | 25 | 8*35 | 125 | 102 | 4-12 | 70-3 |
| 250 | 165 | 250 | 355 | 12-28 | 319 | 405 | 22 | 3 | 45 | 25 | 8*35 | 125 | 102 | 4-12 | 70-3 |
| 300 | 178 | 270 | 410 | 12-28 | 370 | 460 | 24.5 | 4 | 50 | 30 | 8*45 | 175 | 140 | 4-18 | 100-4 |
| 350 | 190 | 290 | 470 | 16-28 | 429 | 520 | 26.5 | 4 | 50 | 40 | 12*45 | 210 | 165 | 4-22 | 130-5 |
| 400 | 216 | 310 | 525 | 16-31 | 480 | 580 | 28 | 4 | 50 | 45 | 14*45 | 210 | 165 | 4-22 | 130-5 |
| 450 | 222 | 330 | 585 | 20-31 | 548 | 640 | 30 | 4 | 50 | 45 | 14*45 | 210 | 165 | 4-22 | 130-5 |
| 500 | 229 | 350 | 650 | 20-34 | 609 | 715 | 31.5 | 4 | 70 | 52 | 16*60 | 210 | 165 | 4-22 | 130-5 |
| 600 | 267 | 390 | 770 | 20-37 | 720 | 840 | 36 | 5 | 90 | 55 | 2*16*70 | 300 | 254 | 8-18 | 200-5 |
| 700 | 292 | 430 | 840 | 24-37 | 794 | 910 | 39.5 | 5 | 90 | 65 | 2*18*70 | 300 | 254 | 8-18 | 200-5 |
| 800 | 318 | 470 | 950 | 24-41 | 901 | 1025 | 43 | 5 | 100 | 70 | 2*20*80 | 300 | 254 | 8-18 | 200-5 |
| 900 | 330 | 510 | 1050 | 28-41 | 1001 | 1125 | 46.5 | 5 | 100 | 80 | 2*22*80 | 300 | 254 | 8-18 | 200-5 |
| 1000 | 410 | 550 | 1170 | 28-44 | 1112 | 1255 | 50 | 5 | 145 | 92 | 2*25*130 | 300 | 254 | 8-18 | 200-5 |
| 1200 | 470 | 630 | 1390 | 32-50 | 1328 | 1485 | 57 | 5 | 145 | 100 | 2*28*130 | 350 | 298 | 8-22 | 230-5 |

Dimensions / JIS10K

| DN | L | | D1 | N-d1 | D2 | D3 | B | F | C | D0 | Key | | UPPER FLANGE | | |
|------|-----------|-----------|------|-------|------|------|----|---|-----|-----|----------|-----|--------------|------|-------|
| | 13 Series | 14 Series | | | | | | | | | B*1 | K | E | Z-d | G-h |
| 100 | 127 | 190 | 175 | 8-19 | 151 | 210 | 18 | 2 | 39 | 16 | 5*30 | 90 | 70 | 4-10 | 55-2 |
| 125 | 140 | 200 | 210 | 8-23 | 182 | 250 | 20 | 2 | 45 | 20 | 6*35 | 125 | 102 | 4-12 | 70-3 |
| 150 | 140 | 210 | 240 | 8-23 | 212 | 280 | 22 | 2 | 45 | 20 | 6*35 | 125 | 102 | 4-12 | 70-3 |
| 200 | 152 | 230 | 290 | 12-23 | 262 | 330 | 22 | 2 | 45 | 25 | 8*35 | 125 | 102 | 4-12 | 70-3 |
| 250 | 165 | 250 | 355 | 12-25 | 324 | 400 | 24 | 2 | 45 | 25 | 8*35 | 125 | 102 | 4-12 | 70-3 |
| 300 | 178 | 270 | 400 | 16-25 | 368 | 445 | 24 | 2 | 50 | 30 | 8*45 | 175 | 140 | 4-18 | 100-4 |
| 350 | 190 | 290 | 445 | 16-25 | 413 | 490 | 26 | 3 | 50 | 40 | 12*45 | 210 | 165 | 4-22 | 130-5 |
| 400 | 216 | 310 | 510 | 16-27 | 475 | 560 | 28 | 3 | 50 | 45 | 14*45 | 210 | 165 | 4-22 | 130-5 |
| 450 | 222 | 330 | 565 | 20-27 | 530 | 620 | 30 | 3 | 50 | 45 | 14*45 | 210 | 165 | 4-22 | 130-5 |
| 500 | 229 | 350 | 620 | 20-27 | 585 | 675 | 30 | 3 | 70 | 52 | 16*60 | 210 | 165 | 4-22 | 130-5 |
| 600 | 267 | 390 | 730 | 24-33 | 690 | 795 | 32 | 3 | 90 | 55 | 2*16*70 | 300 | 254 | 8-18 | 200-5 |
| 700 | 292 | 430 | 840 | 24-33 | 800 | 905 | 34 | 3 | 90 | 65 | 2*18*70 | 300 | 254 | 8-18 | 200-5 |
| 800 | 318 | 470 | 950 | 28-33 | 905 | 1020 | 36 | 3 | 100 | 70 | 2*20*80 | 300 | 254 | 8-18 | 200-5 |
| 900 | 330 | 510 | 1050 | 28-33 | 1005 | 1120 | 38 | 3 | 100 | 80 | 2*22*80 | 300 | 254 | 8-18 | 200-5 |
| 1000 | 410 | 550 | 1160 | 28-39 | 1110 | 1235 | 40 | 3 | 145 | 92 | 2*25*130 | 300 | 254 | 8-18 | 200-5 |
| 1200 | 470 | 630 | 1380 | 32-39 | 1325 | 1465 | 44 | 3 | 145 | 100 | 2*28*130 | 350 | 298 | 8-22 | 230-5 |

Dimensions / ANSI 150

| DN | L | | D1 | N-d1 | D3 | B | C | D0 | Key | | UPPER FLANGE | | |
|------|-----------|-----------|--------|-------|------|-------|-----|-----|----------|-----|--------------|------|-------|
| | 13 Series | 14 Series | | | | | | | B*1 | K | E | Z-d | G-h |
| 100 | 127 | 190 | 190.5 | 8-19 | 230 | 22.3 | 39 | 16 | 5*30 | 90 | 70 | 4-10 | 55-2 |
| 125 | 140 | 200 | 216 | 8-22 | 255 | 22.6 | 45 | 20 | 6*35 | 125 | 102 | 4-12 | 70-3 |
| 150 | 140 | 210 | 241.5 | 8-22 | 280 | 23.9 | 45 | 20 | 6*35 | 125 | 102 | 4-12 | 70-3 |
| 200 | 152 | 230 | 298.5 | 8-22 | 345 | 27 | 45 | 25 | 8*35 | 125 | 102 | 4-12 | 70-3 |
| 250 | 165 | 250 | 362 | 12-25 | 405 | 28.6 | 45 | 25 | 8*35 | 125 | 102 | 4-12 | 70-3 |
| 300 | 178 | 270 | 432 | 12-25 | 485 | 30.2 | 50 | 30 | 8*45 | 175 | 140 | 4-18 | 100-4 |
| 350 | 190 | 290 | 476 | 12-29 | 535 | 33.4 | 50 | 40 | 12*45 | 210 | 165 | 4-22 | 130-5 |
| 400 | 216 | 310 | 540 | 16-29 | 595 | 35 | 50 | 45 | 14*45 | 210 | 165 | 4-22 | 130-5 |
| 450 | 222 | 330 | 578 | 16-32 | 635 | 38.1 | 50 | 45 | 14*45 | 210 | 165 | 4-22 | 130-5 |
| 500 | 229 | 350 | 635 | 20-32 | 700 | 41.3 | 70 | 52 | 16*60 | 210 | 165 | 4-22 | 130-5 |
| 600 | 267 | 390 | 749.5 | 20-35 | 815 | 46.1 | 90 | 55 | 2*16*70 | 300 | 254 | 8-18 | 200-5 |
| 700 | 292 | 430 | 863.5 | 28-35 | 925 | 69.9 | 90 | 65 | 2*18*70 | 300 | 254 | 8-18 | 200-5 |
| 800 | 318 | 470 | 978 | 28.41 | 1060 | 79.4 | 100 | 70 | 2*20*80 | 300 | 254 | 8-18 | 200-5 |
| 900 | 330 | 510 | 1086 | 32-41 | 1170 | 88.9 | 100 | 80 | 2*22*80 | 300 | 254 | 8-18 | 200-5 |
| 1000 | 410 | 550 | 1200 | 36-41 | 1290 | 88.9 | 145 | 92 | 2*25*130 | 300 | 254 | 8-18 | 200-5 |
| 1200 | 470 | 630 | 1422.5 | 40-41 | 1510 | 106.4 | 145 | 100 | 2*28*130 | 350 | 298 | 8-22 | 230-5 |

NOMENCLATURE

| Designation | Materials |
|-------------------|-----------------|
| 1 Bushing | Bronze / EPDM |
| 2 Bottom Shaft | SS420 |
| 3 Body | GGG50 |
| 4 Packing | EPDM |
| 5 Retainer | CS EPOXY COATED |
| 6 Taper Pin | SS416 |
| 7 Disc | GGG450 |
| 8 Disc Sealing | EPDM |
| 9 Stuffing Flange | GGG50 |
| 10 Support | CS |
| 11 Top Shaft | SS420 |
| 12 Cover | GGG50 |
| 13 All Fasteners | A2-70 |



DIMENSIONS

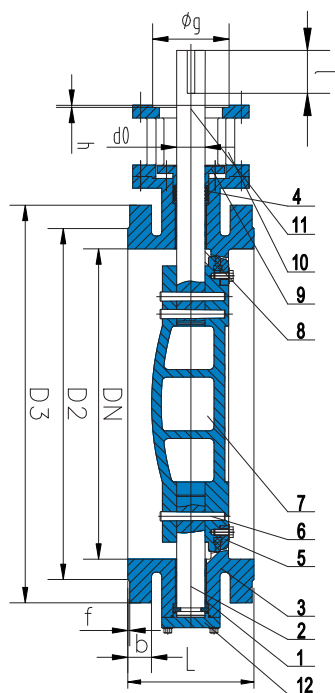
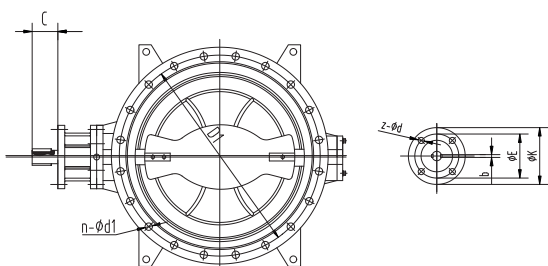

Dimensions / PN25

| DN | L | | D1 | N-d1 | D2 | D3 | B | F | C | D0 | Key | | UPPER FLANGE | | |
|------|-----------|-----------|------|-------|------|------|------|---|-----|-----|----------|-----|--------------|------|-------|
| | 13 Series | 14 Series | | | | | | | | | B*l | K | E | Z-d | G-h |
| 100 | 127 | 190 | 190 | 8-23 | 156 | 235 | 19 | 3 | 39 | 16 | 5*30 | 90 | 70 | 4-10 | 55-2 |
| 125 | 140 | 200 | 220 | 8-28 | 184 | 270 | 19 | 3 | 45 | 20 | 6*35 | 125 | 102 | 4-12 | 70-3 |
| 150 | 140 | 210 | 250 | 8-28 | 211 | 300 | 20 | 3 | 45 | 20 | 6*35 | 125 | 102 | 4-12 | 70-3 |
| 200 | 152 | 230 | 310 | 12-28 | 274 | 360 | 22 | 3 | 45 | 25 | 8*35 | 125 | 102 | 4-12 | 70-3 |
| 250 | 165 | 250 | 370 | 12-31 | 330 | 425 | 24.5 | 3 | 45 | 25 | 8*35 | 125 | 102 | 4-12 | 70-3 |
| 300 | 178 | 270 | 430 | 16-31 | 389 | 485 | 27.5 | 4 | 50 | 30 | 8*45 | 175 | 140 | 4-18 | 100-4 |
| 350 | 190 | 290 | 490 | 16-34 | 448 | 555 | 30 | 4 | 50 | 40 | 12*45 | 210 | 165 | 4-22 | 130-5 |
| 400 | 216 | 310 | 550 | 16-37 | 503 | 620 | 32 | 4 | 50 | 45 | 14*45 | 210 | 165 | 4-22 | 130-5 |
| 450 | 222 | 330 | 600 | 20-37 | 548 | 670 | 34.5 | 4 | 50 | 45 | 14*45 | 210 | 165 | 4-22 | 130-5 |
| 500 | 229 | 350 | 660 | 20-37 | 609 | 730 | 36.5 | 4 | 70 | 52 | 16*60 | 210 | 165 | 4-22 | 130-5 |
| 600 | 267 | 390 | 770 | 20-41 | 720 | 845 | 42 | 5 | 90 | 55 | 2*16*70 | 300 | 254 | 8-18 | 200-5 |
| 700 | 292 | 430 | 875 | 24-44 | 820 | 960 | 46.5 | 5 | 90 | 65 | 2*18*70 | 300 | 254 | 8-18 | 200-5 |
| 800 | 318 | 470 | 990 | 24-50 | 928 | 1085 | 51 | 5 | 100 | 70 | 2*20*80 | 300 | 254 | 8-18 | 200-5 |
| 900 | 330 | 510 | 1090 | 28-50 | 1028 | 1185 | 55.5 | 5 | 100 | 80 | 2*22*80 | 300 | 254 | 8-18 | 200-5 |
| 1000 | 410 | 550 | 1210 | 28-57 | 1140 | 1320 | 60 | 5 | 145 | 92 | 2*25*130 | 300 | 254 | 8-18 | 200-5 |
| 1200 | 470 | 630 | 1420 | 32-57 | 1350 | 1530 | 69 | 5 | 145 | 100 | 2*28*130 | 350 | 298 | 8-22 | 230-5 |

NOMENCLATURE

| Designation | Materials |
|-------------------|-----------------------|
| 1 Bushing | Bronze / Brass / PTFE |
| 2 Bottom Shaft | SS431 |
| 3 Body | GGG50 |
| 4 Packing | EPDM |
| 5 Retainer | CS EPOXY COATED |
| 6 Taper Pin | SS416 |
| 7 Disc | GGG450 |
| 8 Disc Sealing | EPDM |
| 9 Stuffing Flange | GGG50 |
| 10 Support | CS |
| 11 Top Shaft | SS431 |
| 12 Cover | GGG50 |
| 13 All Fasteners | A2-70 |



Omeax SARL

Contact@omeax.com - <http://www.omeax.com>

Omeax is not responsible for any possible errors in catalogue, brochures and on website. This datasheet is subject to change without notice. All right reserved.

26/12/24
Page 3

Flange to EN1092/ISO7005, face to face length to EN558-1/ISO5752 series 13, 14 or 12.

T profiled disc seal ring fixed by retainer ensures the reliable sealing performance in both direction, which is also easy to be adjusted or replaced without any special tools.

Multiple shaft O rings provide long life and reliable sealing performance, which is easy to be adjusted or replace.

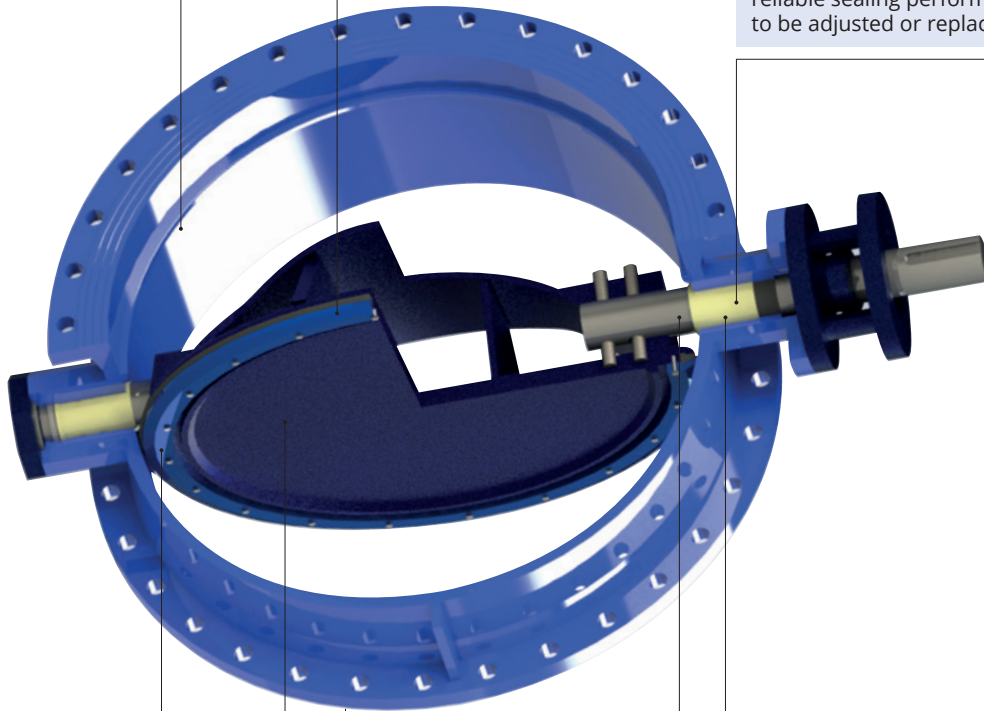

Stainless steel fasteners.

Disc to shaft connection by means of key, or taper pin.

Self lubricating bearing of Al-bronze material, free from maintenance.

Streamlined low profiled disc ensures the lower flow resistance.

Stainless steel welded and finished body seat ensures reliable and durable performance.

